



NYC Parks



**Environmental
Protection**

PARK SLOPE PLAYGROUND

Located between Lincoln Place, Berkeley Place, 5th Avenue, and 6th Avenue, in the borough of Brooklyn

DEP Schematic Green
Infrastructure Submission

- **Project Site:** Park Slope Playground(JOP)
- **Project Goal:** Install green infrastructure to manage impervious area within Park Slope Playground to improve water quality in the Gowanus Canal by reducing combined sewer overflows.
- **Project Scope:**
 - Turf field under existing play yard along Berkeley Place, shared with PS 282
 - Replacement of existing baseball area with turf field, repavement of full yard, repair of sinkhole, addition of painted track surrounding yard and benches and trees in the middle of the yard
- **Project Cost:** \$420,000
- **Construction Duration:** 3 months total
 - Full closure of the existing play yard shared with PS 282 for approximately 3 months
- **Annual Volume Managed:** 951,880 gals
- **Impervious Area Managed:** 12,850 sf
- **Lot Size:** 47,000 sf
- **BBL:** 300950019/300950024



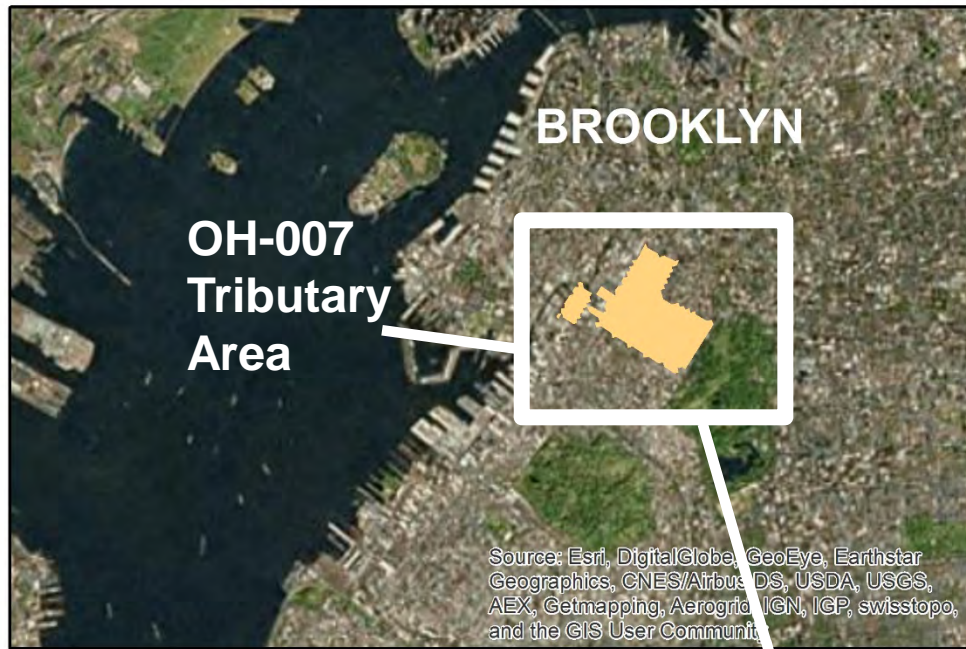

CITY

0 2 Miles



NEIGHBORHOOD

0 1,000 Feet



SITE

0 100 Feet



PARK SLOPE PLAYGROUND | Project Location

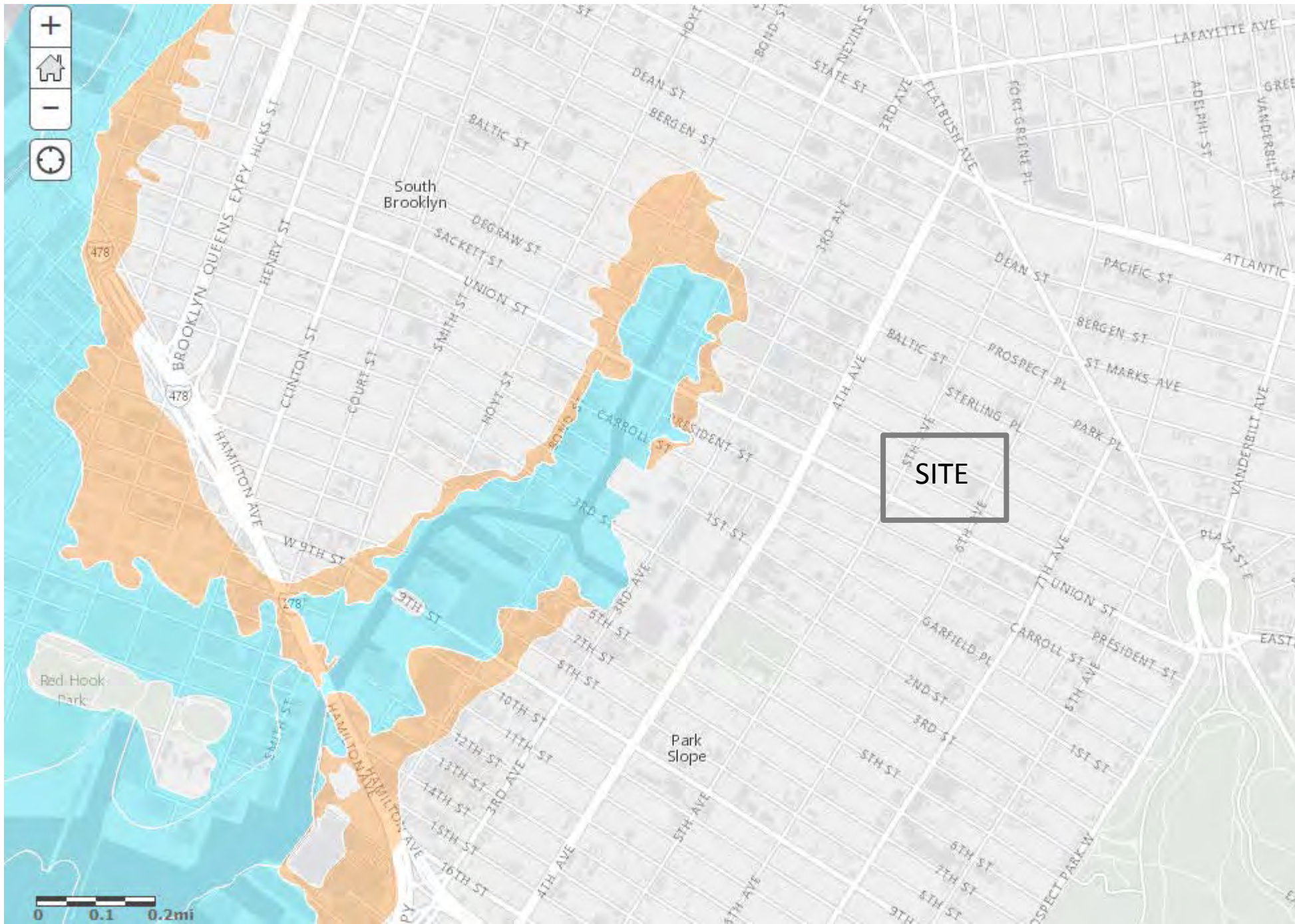

FLOOD HAZARD ZONES

- ZONE A** – 1% annual-chance flood event. No Base Flood Elevation (BFE) exists.
- ZONE AE** – 1% annual-chance flood event. BFE exists.
- ZONE AO** – 1% annual-chance shallow flooding.
- VE** – Areas along coasts subject to inundation by the 1% annual-chance flood event with additional hazards associated with storm-induced velocity wave action. BFE exists.
- FLOODWAY** – watercourse reserved to discharge base flood.
- ZONE X** – Moderate risk areas within the 0.2% annual-chance floodplain.
- LIMIT OF MODERATE WAVE ACTION**



NYC Parks



PARK SLOPE PLAYGROUND | Flood Risk



LAND USE CATEGORIES

- 1 AND 2 FAMILY RESIDENTIAL
- MULTI-FAMILY RESIDENTIAL
- MIXED USE
- COMMERCIAL
- INDUSTRIAL
- TRANSPORTATION/ UTILITIES
- INSTITUTIONAL
- OPEN SPACE AND OUTDOOR RECREATION
- PARKING
- VACANT LOTS

Sources: Esri, HERE, DeLorme, USGS, Intermap, increment P Corp., NRCAN, Esri Japan, METI, Esri China (Hong Kong), Esri (Thailand), MapmyIndia, © OpenStreetMap contributors, and the GIS User Community



0 250 Feet



NYC Parks



PARK SLOPE PLAYGROUND | Surrounding Land Use

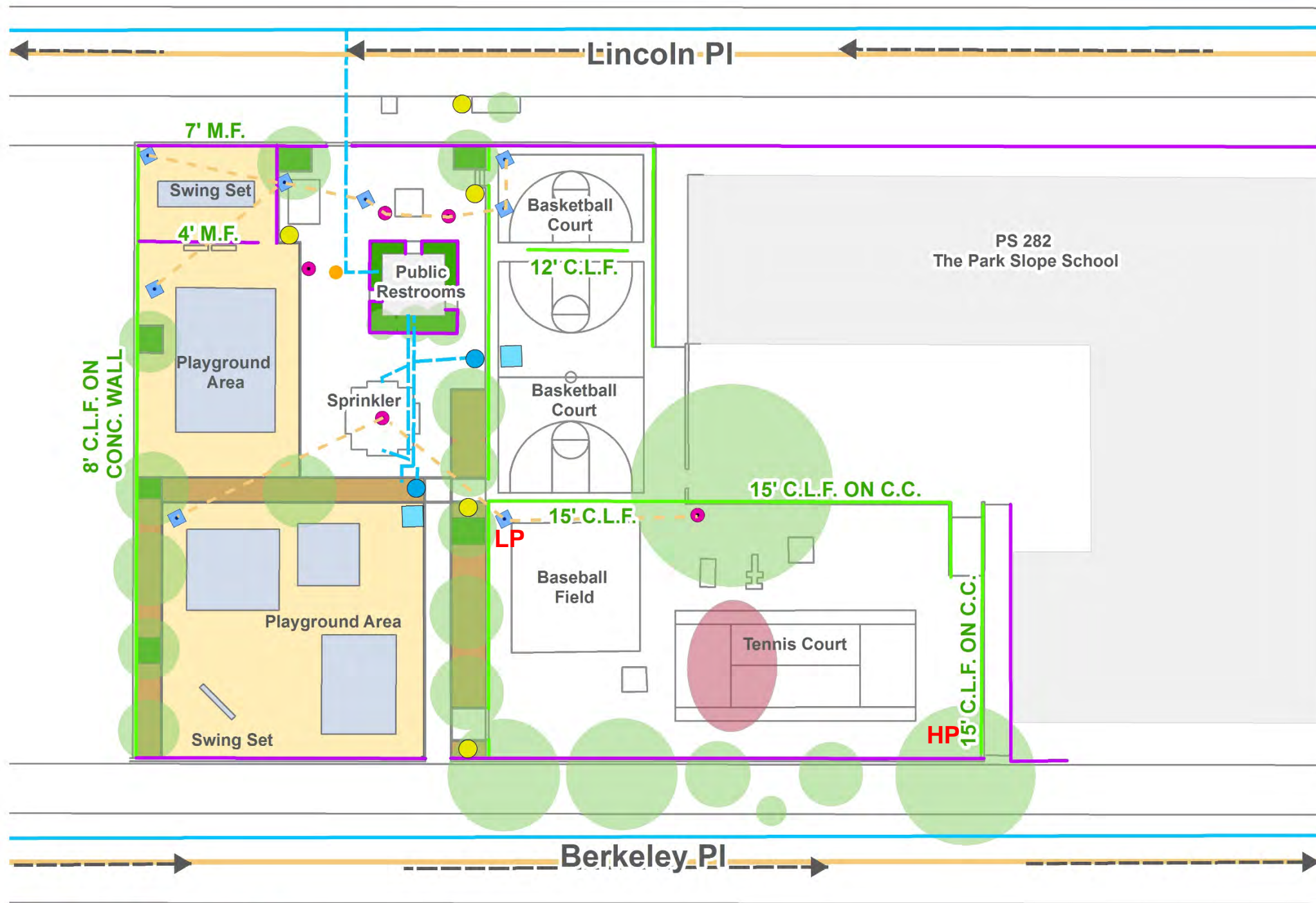

LEGEND

- Flagpole
- Light Pole
- Drinking Fountain
- - -> Vehicle Traffic
- Sewer Main
- - - Storm Sewer
- Water Main
- - - Water Service
- Steel Fence

Existing Drainage Structure

- Manhole
- Catchbasin
- ◊ Existing Dry Wells
- Chain Link Fence
- Pavement Settling
- Existing Building
- Play Equipment
- Tree Canopy
- Concrete Pavers
- Planting Bed
- Play Surface
- HP High Point
- LP Low Point



PARK SLOPE PLAYGROUND | Existing Conditions



Photo 1 and 2: Vicinity of Proposed Synthetic Turf Field

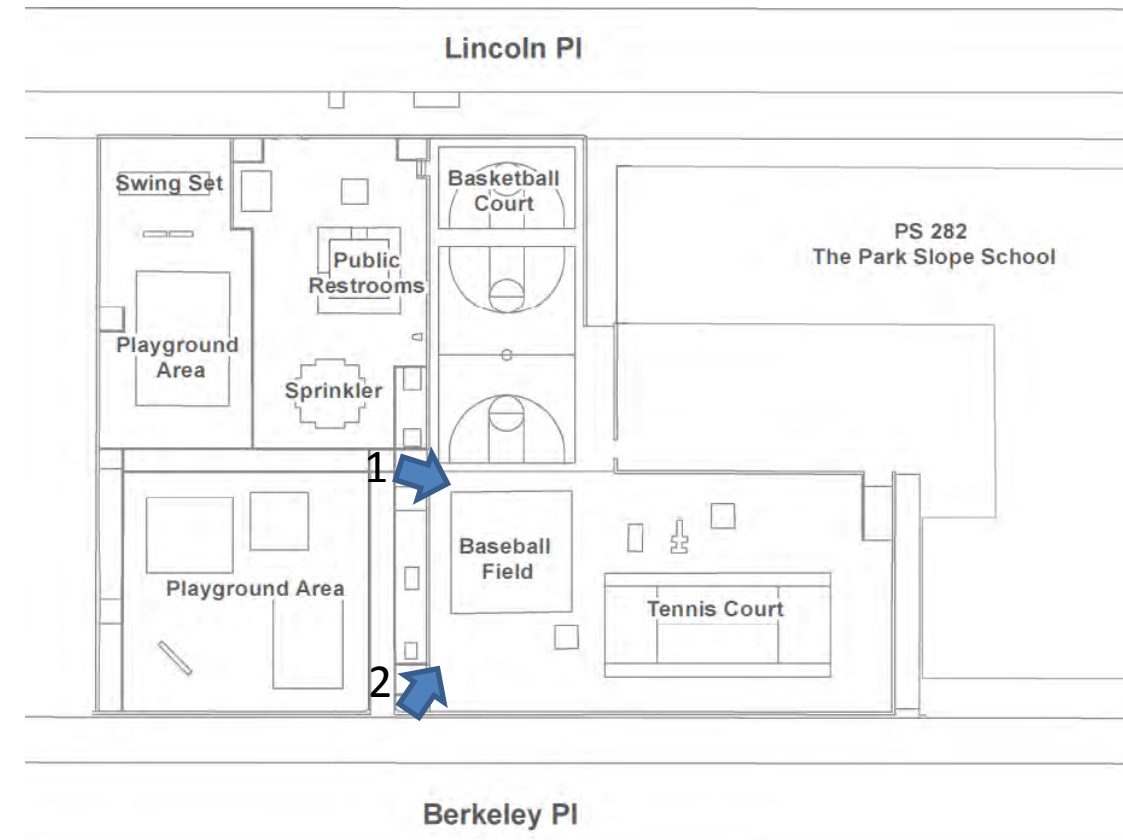

PARK SLOPE PLAYGROUND | Existing Site Photograph

Lincoln Pl

Berkeley Pl

LEGEND

- Tree Canopy
- Trunk DBH
- Absolute Critical Root Zone
- ISA Critical Root Zone
- Existing Drainage Structure*
 - Manhole
 - Catchbasin

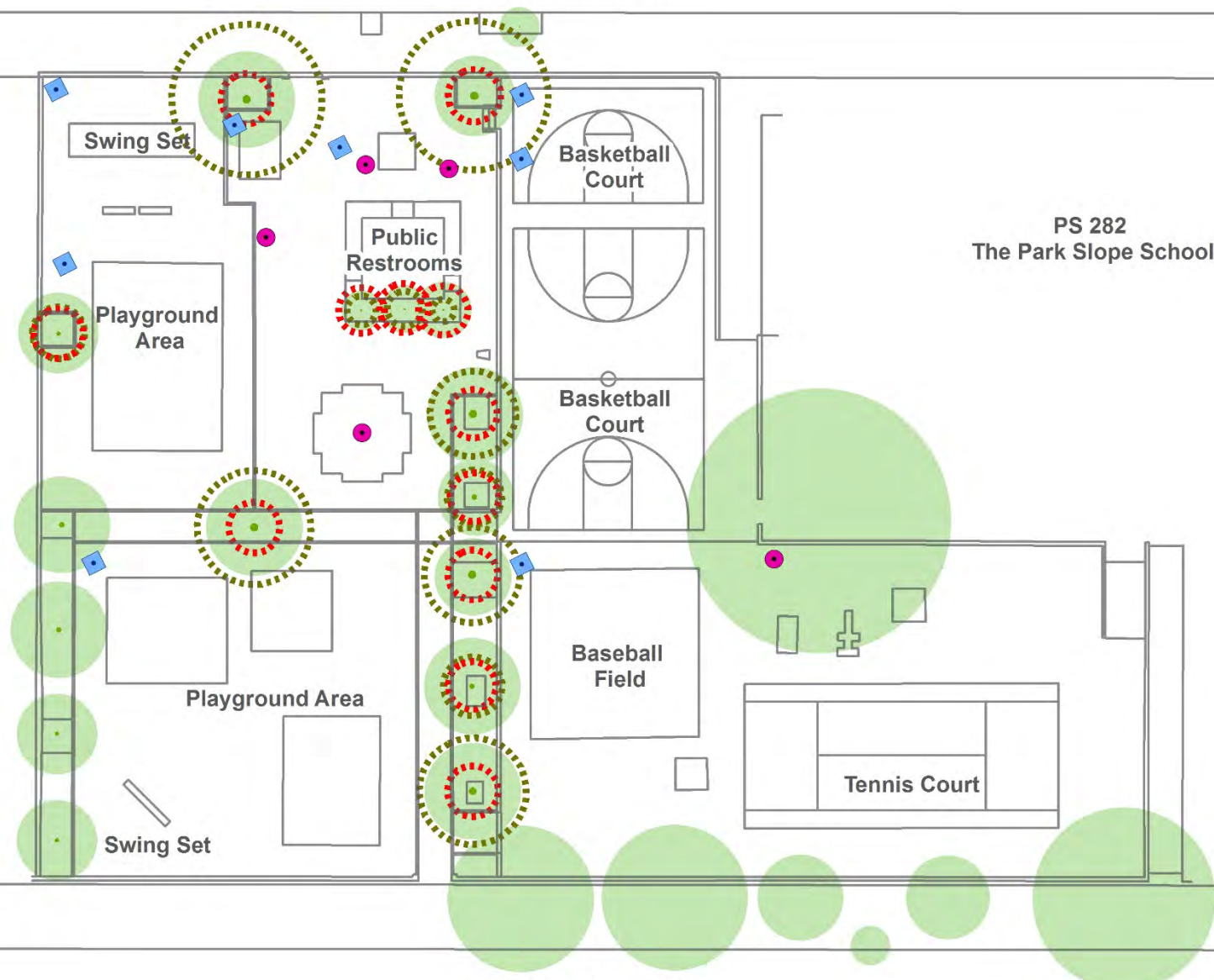

PS 282
The Park Slope School



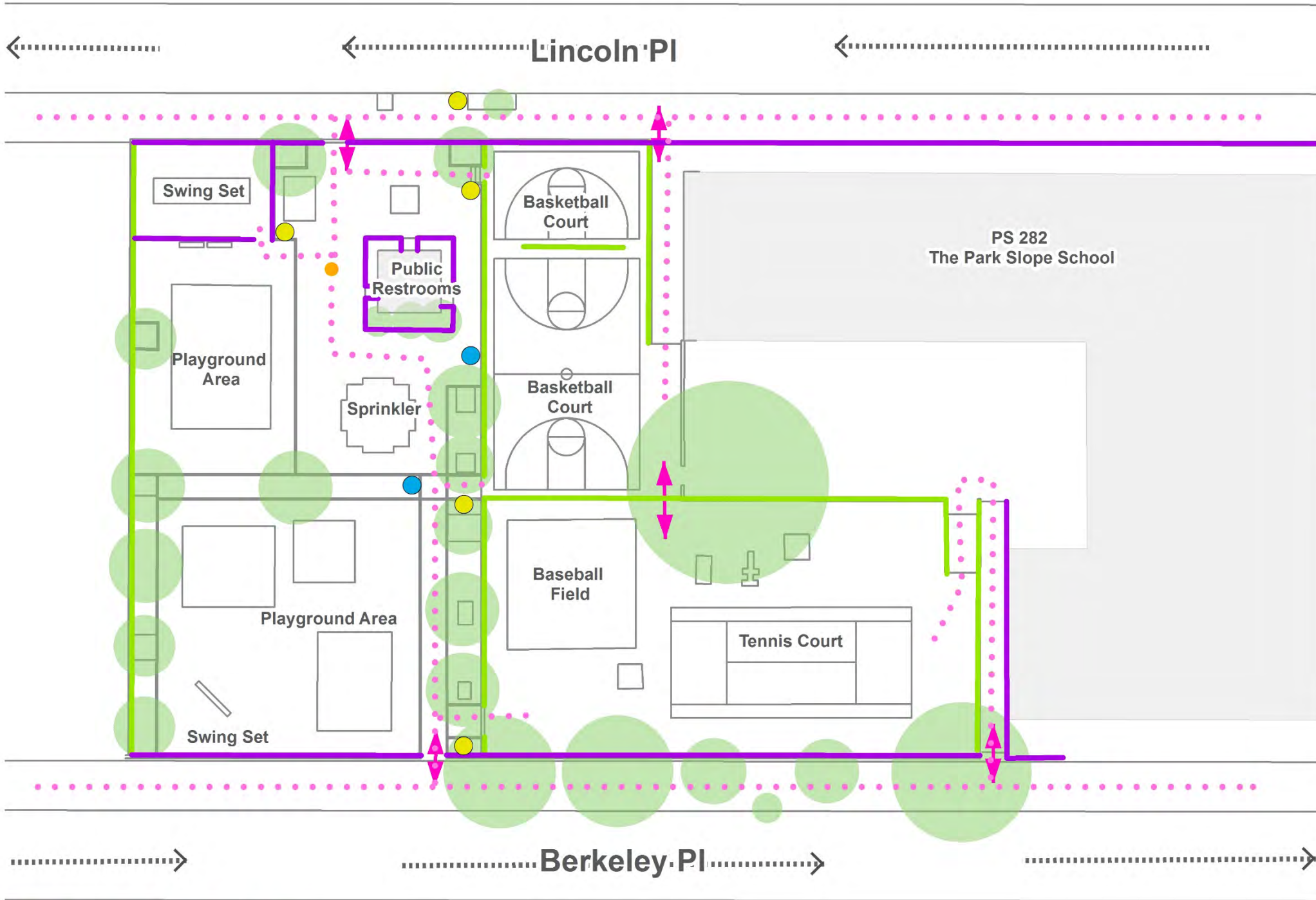

LEGEND

- Park Circulation
- Pedestrian Traffic
- Vehicle Traffic
- Existing Building
- Tree Canopy
- Flagpole
- Drinking Fountain
- Light Pole
- Chain Link Fence
- Steel Fence



PARK SLOPE PLAYGROUND | Site Analysis

Lincoln PI

LEGEND

→ Direction of Surface Flow

— Existing Sewer Main

- - - Storm Sewer

Existing Drainage Structure

● Manhole

■ Catchbasin

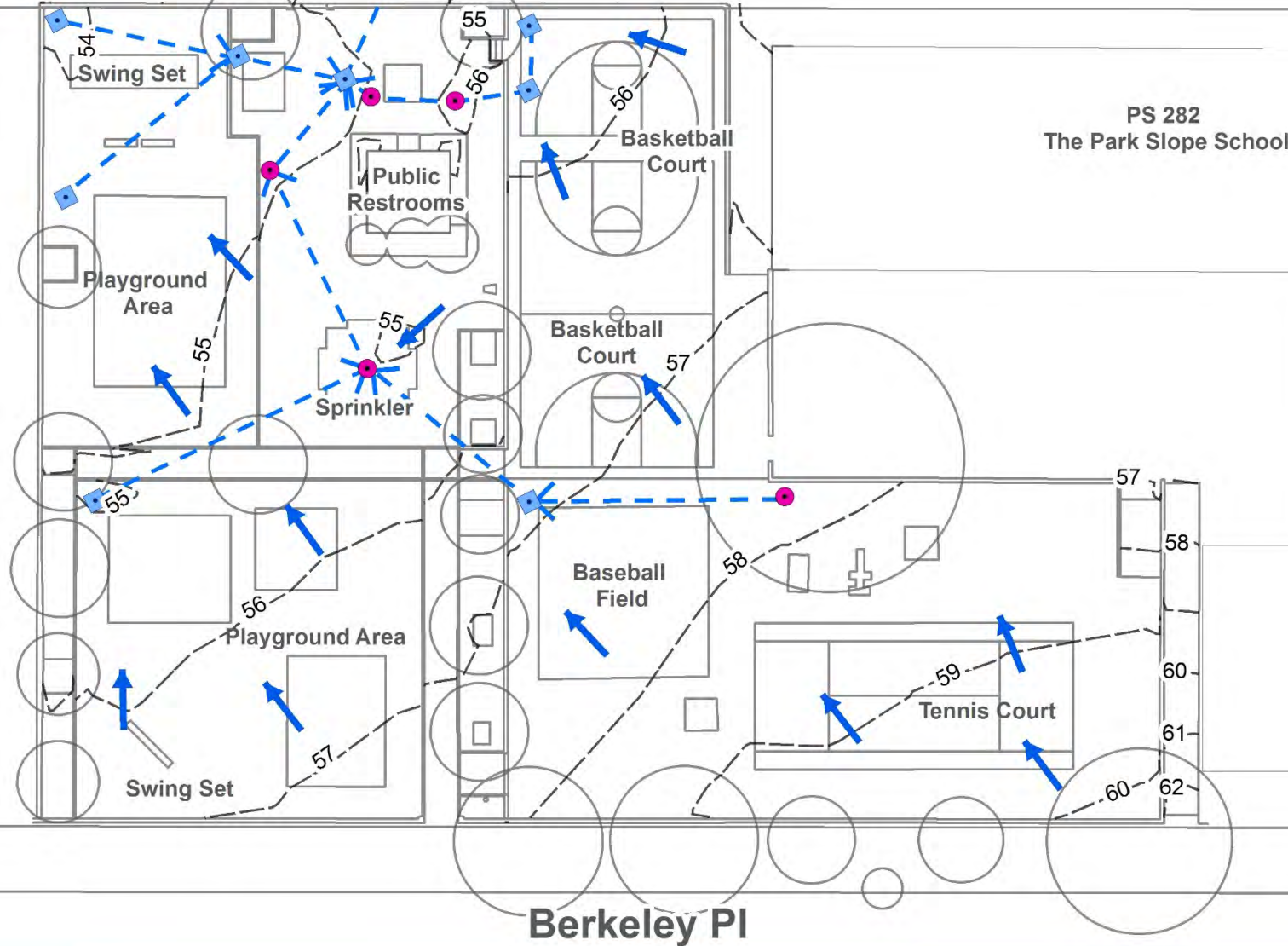

Berkeley PI



PARK SLOPE PLAYGROUND | Existing Drainage Plan

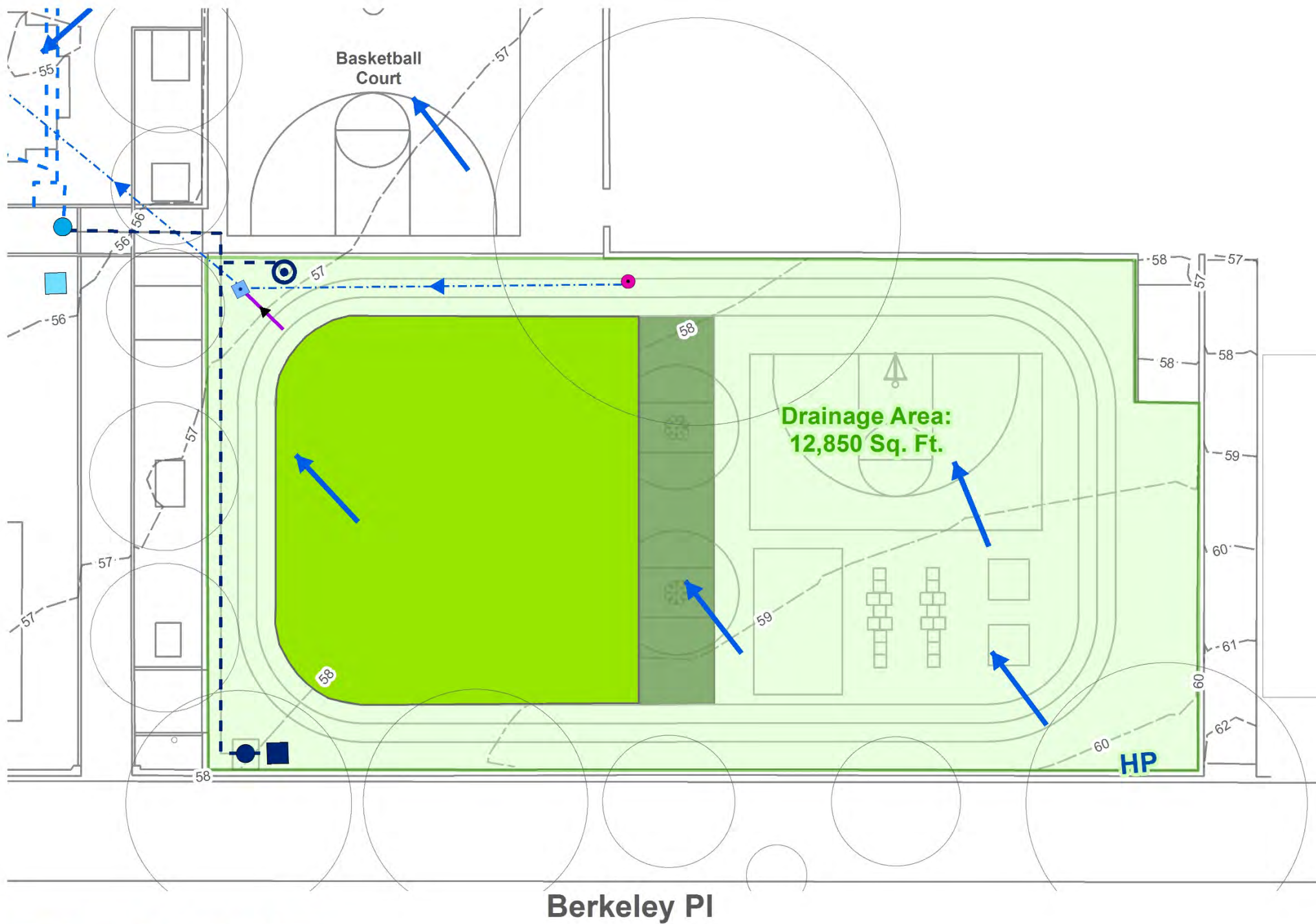

LEGEND

- Existing Drinking Fountain
 - Proposed Accessible Hi/Lo Drinking Fountain with Bottle Filler
 - Proposed Mister
 - - - Existing Water Service
 - - - Proposed Water Service
 - Existing Dry Wells
 - Proposed Dry Well
 - ▶ Proposed Drainage Piping
 - Existing Drainage Structure*
 - Manhole
 - Catchbasin
 - - -▶ Storm Drain
 - ▶ Direction of Surface Flow
 - Tree Canopy
 - Synthetic Turf
 - Seating Area/ Infiltration Strip
 - Drainage Area to Synthetic Turf
- 0 10 20 Feet N

LEGEND

- Existing Pervious Area
- Tree Canopy

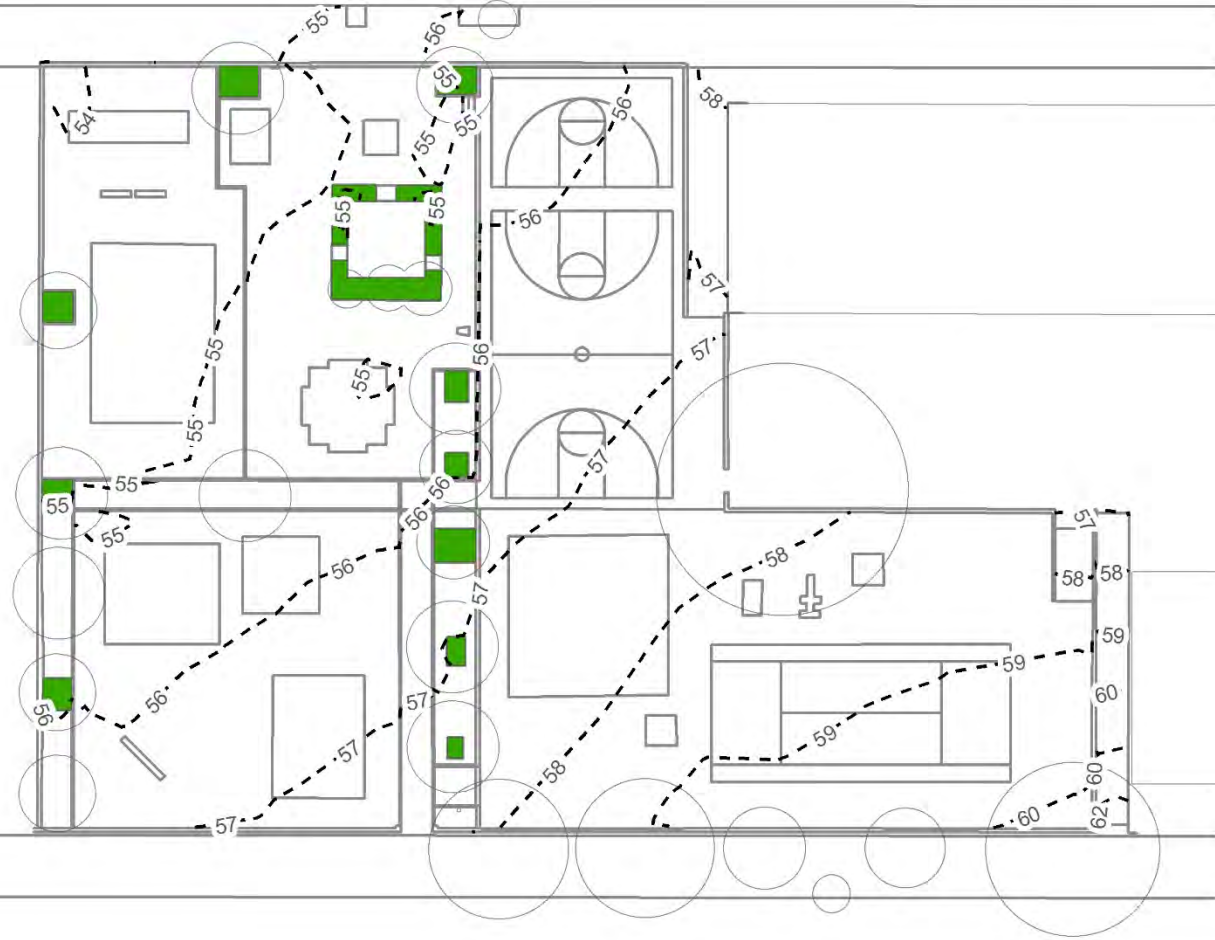

Existing: 2.4% Pervious Surfaces

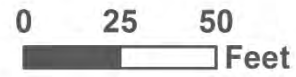

LEGEND

- Synthetic Turf
- Seating/Infiltration Area
- Existing Pervious Area
- Tree Canopy

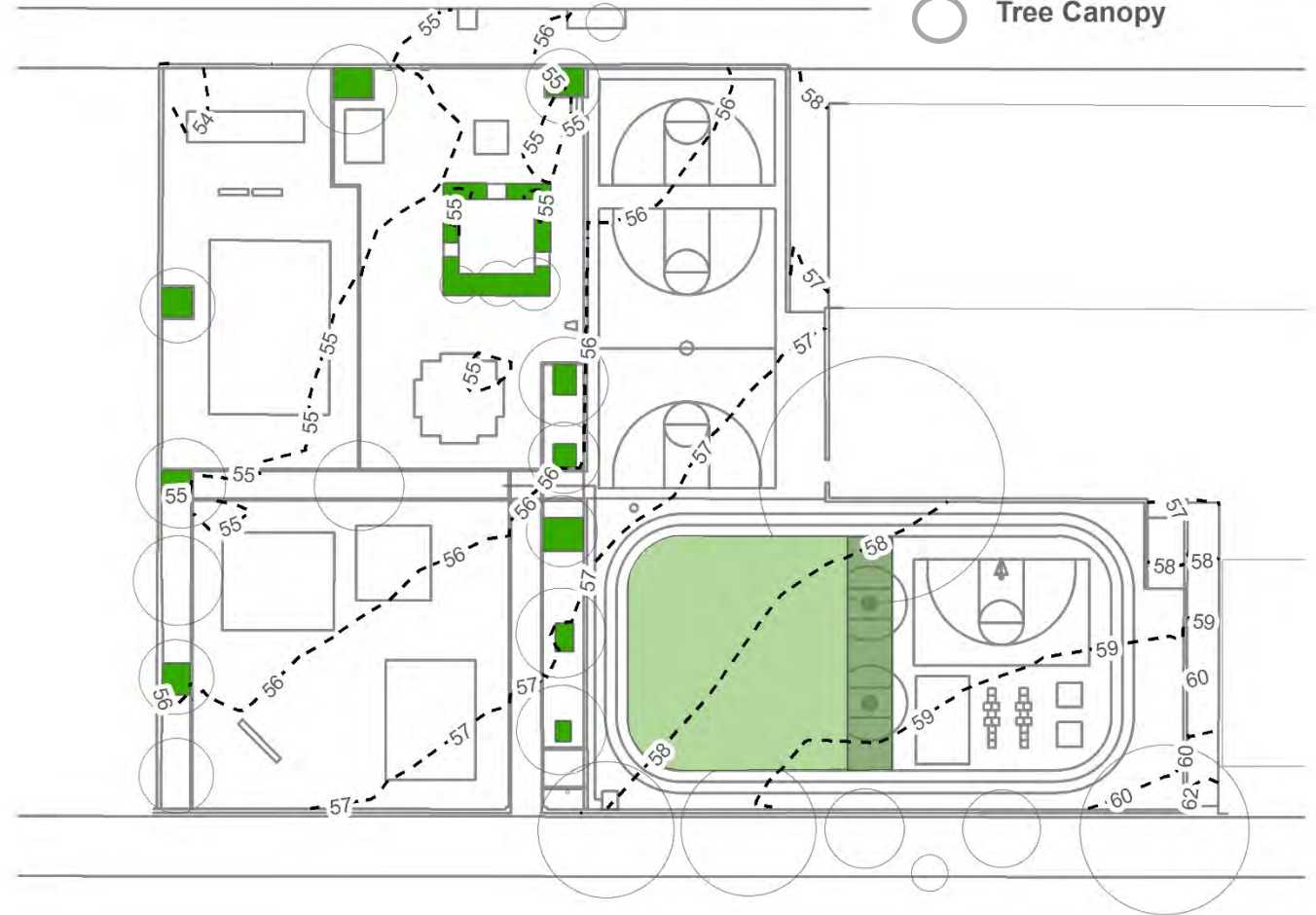

Proposed: 11.7% Pervious Surfaces

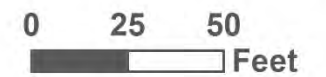

PARK SLOPE PLAYGROUND | Pervious Surface Area Plans

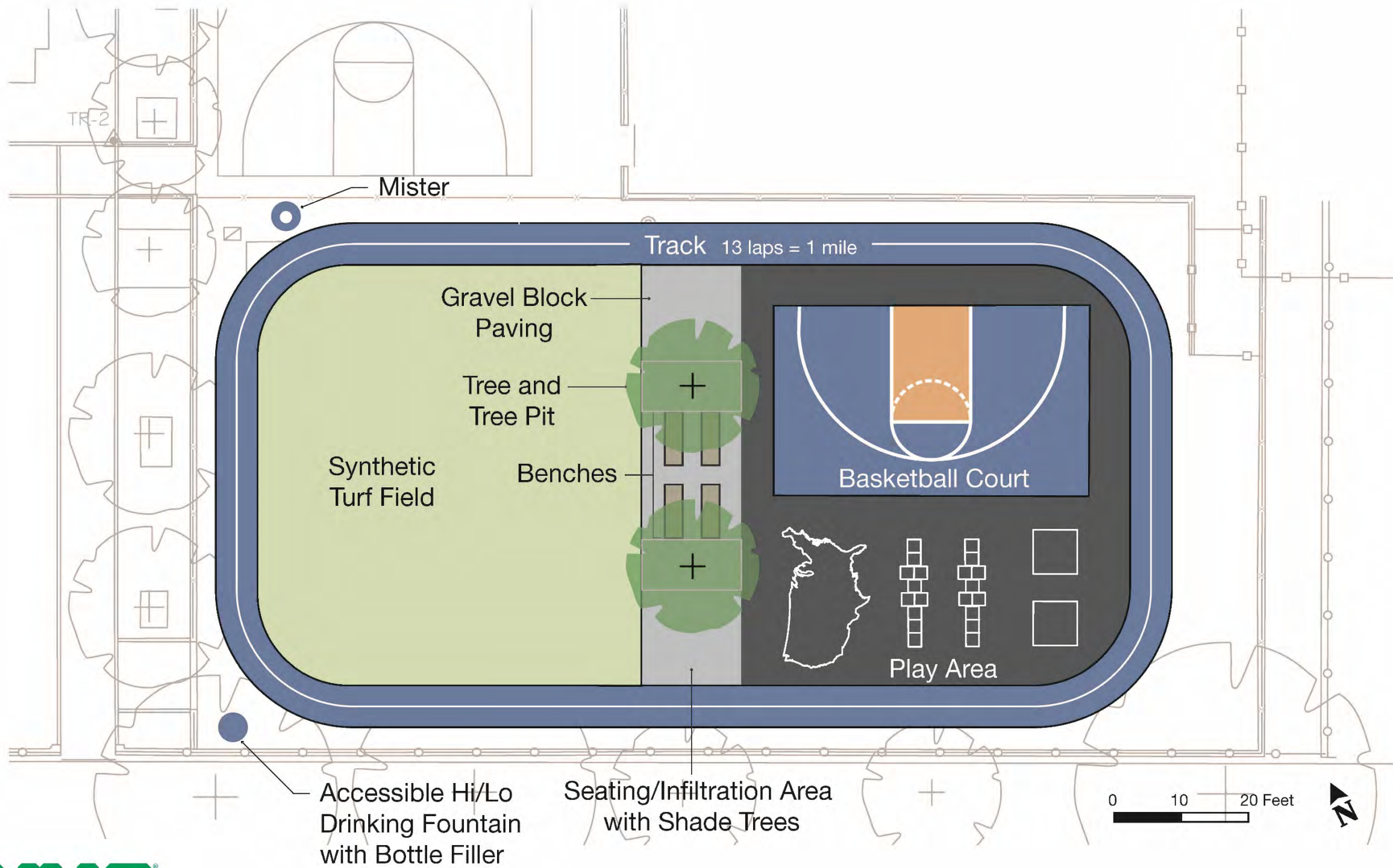

PARK SLOPE PLAYGROUND | Materials Plan

Planting



TREE /Sweetgum

Materials



Backless Benches



Full Depth Asphalt

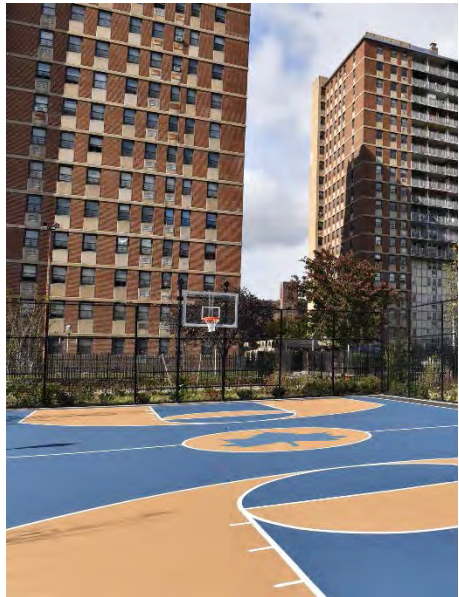

Basketball Court



Granite Block Paving



Accessible Hi/Lo Water Fountain with Bottle Filler

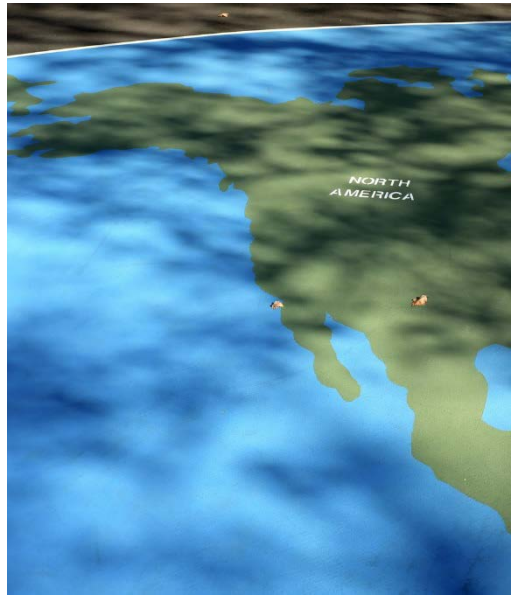

USA Map and Painted Games



Painted Track



Synthetic Turf



Mister



PARK SLOPE PLAYGROUND | Materials

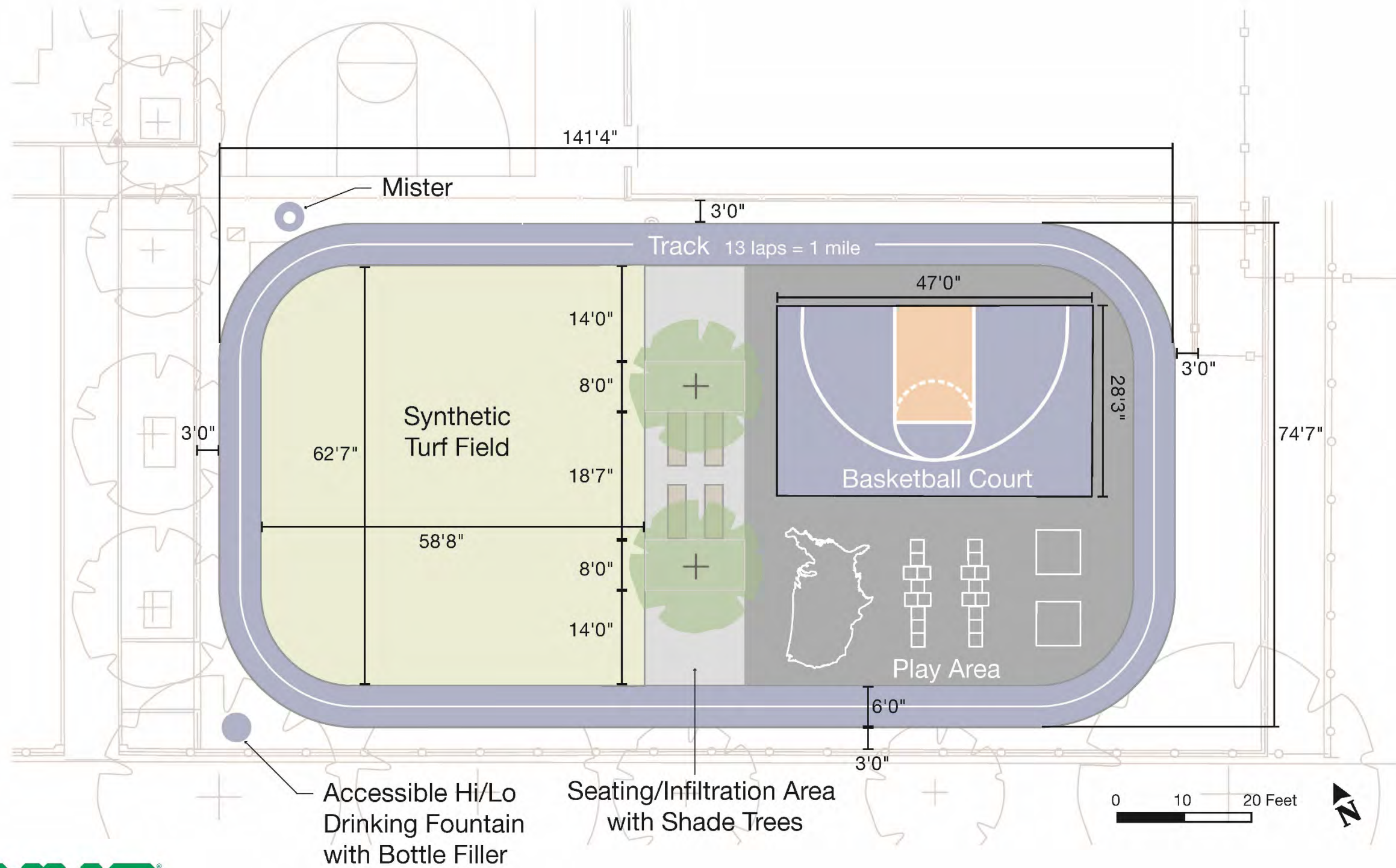



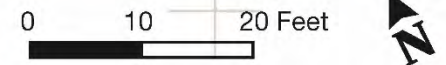

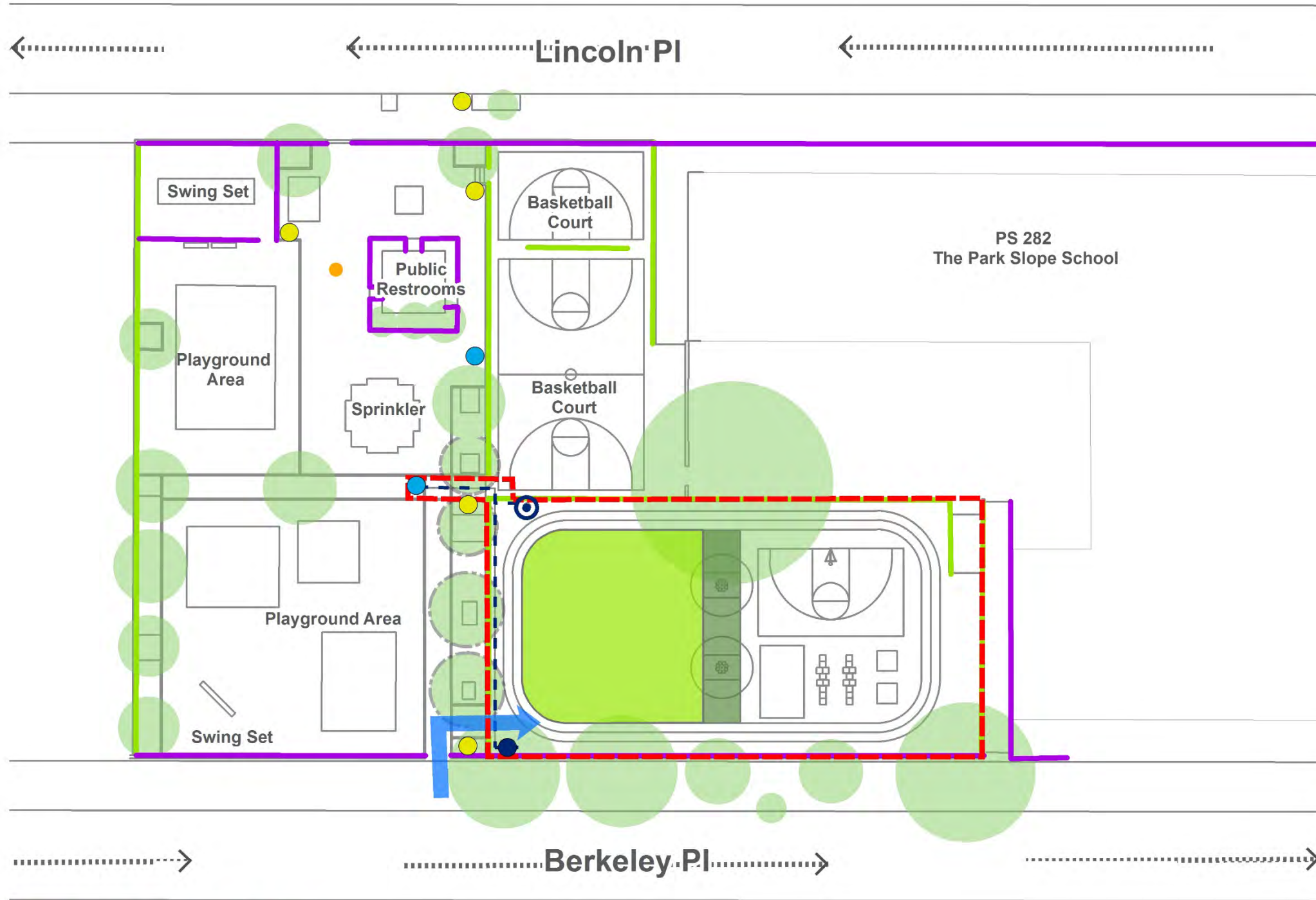











PARK SLOPE PLAYGROUND | Layout Plan





LEGEND

-  Construction Entrance
-  Limit of Work
-  Vehicle Traffic
-  Tree Canopy
-  Protection
-  Protection and Pruning
-  Synthetic Turf
-  Seating/ Infiltration Area
-  Proposed Accessible Hi/Lo Drinking Fountain with Bottle Filler
-  Proposed Mister
-  Proposed Water Service
-  Flagpole
-  Existing Drinking Fountain
-  Light Pole
-  Chain Link Fence
-  Steel Fence



- **Project Goal**

- Install synthetic turf to manage impervious areas within Park Slope Playground to reduce combined sewer overflows.

- **Limited Construction Impacts**

- Basketball courts maintained, minimal impacts to open portion of playground

- **Project Benefits**

- **Aesthetics:** Synthetic turf and proposed trees will provide additional greenery to play yard. Colored track and games will provide colorful play areas and enhance currently paved area.
- **Educational Opportunity:** Synthetic turf will be installed in play yard commonly used by PS 282 and visible to the public.
- **Community Engagement:** Chance to engage children and the community with green infrastructure and sustainable design



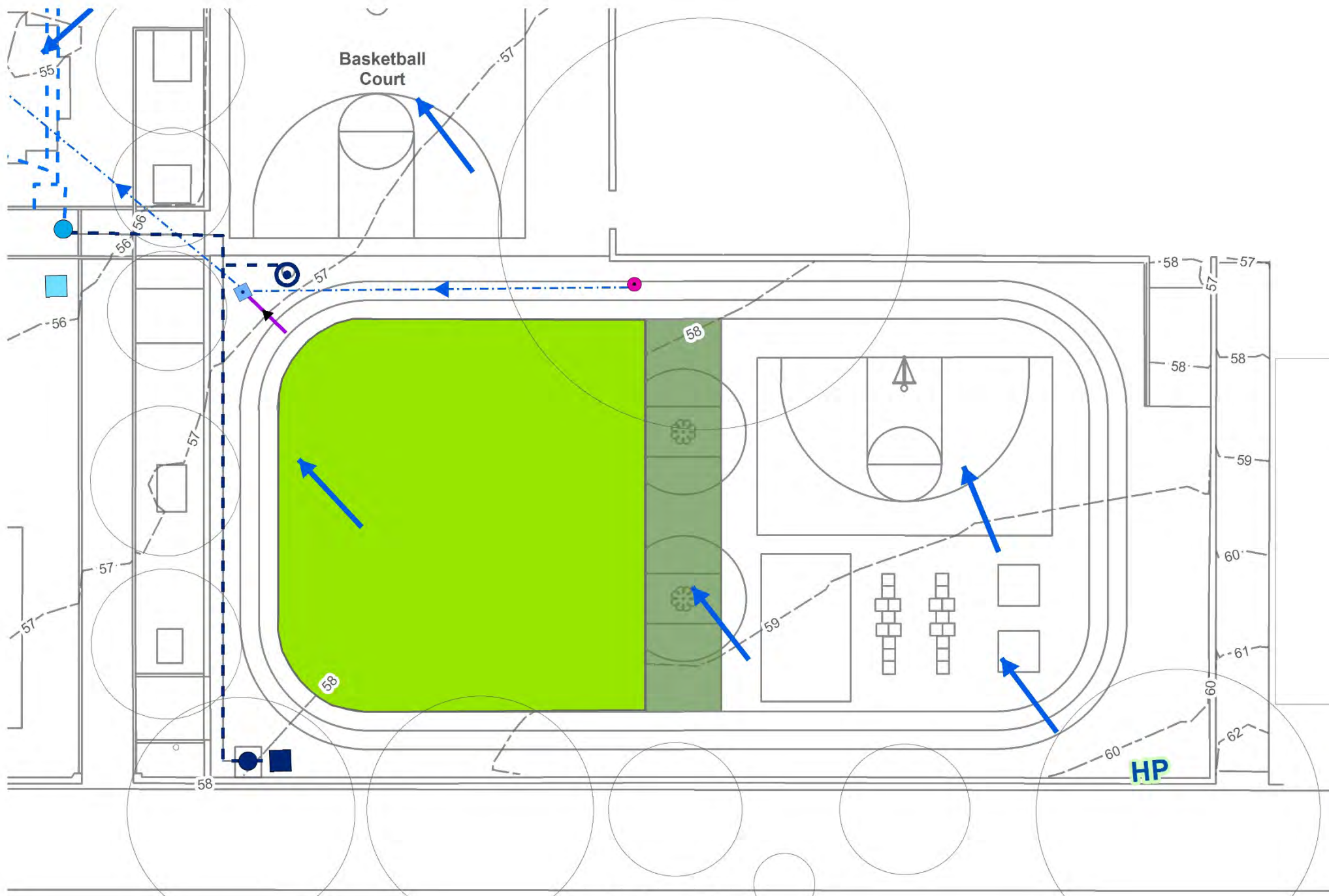

LEGEND

- Existing Drinking Fountain
- Proposed Accessible Hi/Lo Drinking Fountain with Bottle Filler
- ⊙ Proposed Mister
- - - Existing Water Service
- - - Proposed Water Service
- ◊ Existing Dry Wells
- ◼ Proposed Dry Well
- Proposed Drainage Piping
- Existing Drainage Structure*
- Manhole
- ◻ Catchbasin
- Storm Drain
- Direction of Surface Flow
- Tree Canopy
- Synthetic Turf
- Seating/ Infiltration Area

Berkeley Pl



PARK SLOPE PLAYGROUND | Schematic Green Infrastructure